

**Schedule 12**

**Part A**

Regulation 33,34

**Premises Licence**

**Premises Licence Number**

1601349GLPRMV

**Part 1 – Premises Details**

**Postal address:**

**Olympus Cafe Bar  
162-170 Barton Street  
Gloucester  
Gloucestershire  
GL1 4EU**

**Telephone number**

01452 525917

**Where the licence is time limited the dates**

Not applicable

Licensable activities authorised by the licence and the times the licence authorises the carrying out of licensable activities

Sale of Alcohol	Everyday	12:00 - 23:00
Plays	Everyday	10:00 - 00:00
Films	Everyday	10:00 - 00:00
Boxing or Wrestling Entertainment	Everyday	10:00 - 00:00
Live Music	Everyday	10:00 - 00:00
Recorded Music	Everyday	10:00 - 00:00
Performance of Dance	Everyday	10:00 - 00:00
Making Music	Everyday	10:00 - 00:00
Dancing	Everyday	10:00 - 00:00

Sale of alcohol on New Year's Eve from the start of permitted hours on New Year's Eve to the end of permitted hours on New Year's Day

**PUBLIC PROTECTION**

**The opening hours of the premises**

Everyday 10:00 - 00:00

Sale of alcohol on New Year's Eve from the start of permitted hours on New Year's Eve to the end of permitted hours on New Year's Day

**Where the licence authorises supplies of alcohol whether these are on and / or off supplies**

Alcohol is supplied for consumption on the Premise

**Part 2**

**Name, (registered) address, telephone number and email (where relevant) of holder of premises licence**

Arben Ndreu  
162-170 Barton Street  
Gloucester  
GL1 4EU

**Registered number of holder, for example company number, charity number (where applicable)**

**Name, address and telephone number of designated premises supervisor where the premises licence authorises for the supply of alcohol**

**Arben Ndreu**  
**121 Ryecroft Street**  
**Gloucester**  
**GL1 4ND**

**PUBLIC PROTECTION**

Gloucester City Council  
Herbert Warehouse  
The Docks  
Gloucester GL1 2EQ

Tel 01452 396303 Fax 01452 396340  
Email [licence.team@gloucester.gov.uk](mailto:licence.team@gloucester.gov.uk)  
Minicom 01452 396161  
[www.gloucester.gov.uk](http://www.gloucester.gov.uk)

**1601349GLPRMV**

Page 2 of 7

**Personal licence number and issuing authority of personal licence held by designated premises supervisor where the premises licence authorises for the supply of alcohol**

GLPER/1439

Licensing Authority: Gloucester City Council



**Signature of Issuing Officer:**

**Food, Licensing & Markets Service Manager  
Public Protection**

**Date Licence First Granted** 15 December 2005

**Date of Issue:** 9 September 2016

Issuing Authority:

The District of Gloucester City Council, The Docks, Gloucester GL1 2EQ

## **PUBLIC PROTECTION**

Gloucester City Council  
Herbert Warehouse  
The Docks  
Gloucester GL1 2EQ

**Tel** 01452 396303 **Fax** 01452 396340  
**Email** [licence.team@gloucester.gov.uk](mailto:licence.team@gloucester.gov.uk)  
**Minicom** 01452 396161  
[www.gloucester.gov.uk](http://www.gloucester.gov.uk)

**1601349GLPRMV**

Page 3 of 7

## **Annex 1 – Mandatory conditions**

### **Where licence authorises supply of alcohol**

No supply of alcohol may be made under this licence

- a. at a time when there is no designated premises supervisor in respect of this licence, or
- b. at a time when the designated premises supervisor does not hold a personal licence or his personal licence is suspended

Every supply of alcohol under this licence must be made or authorised by a person who holds a personal licence.

### Irresponsible Drinks Promotions

- 1 (1) The responsible person must ensure that staff on relevant premises do not carry out, arrange or participate in any irresponsible promotions in relation to the premises.

(2) In this paragraph, an irresponsible promotion means any one or more of the following activities, or substantially similar activities, carried on for the purpose of encouraging the sale or supply of alcohol for consumption on the premises-

(a) games or other activities which require or encourage, or are designed to require or encourage, individuals to -

(i) drink a quantity of alcohol within a time limit (other than to drink alcohol sold or Supplied on the premises before the cessation of the period in which the responsible person is authorised to sell or supply alcohol), or

(ii) drink as much alcohol as possible (whether within a time limit or otherwise);

(b) provision of unlimited or unspecified quantities of alcohol free or for a fixed or discounted fee to the public or to a group defined by a particular characteristic in a manner which carries a significant risk of undermining a licensing objective.

(c) provision of free or discounted alcohol or any other thing as a prize to encourage or reward the purchase and consumption of alcohol over a period of 24 hours or less in a manner which carries a significant risk of undermining a licensing objective.

(d) selling or supplying alcohol in association with promotional posters or flyers on, or in the vicinity of, the premises which can reasonably be considered to condone, encourage or glamorise anti-social behaviour or to refer to the effects of drunkenness in any favourable manner.

(e) Dispensing alcohol directly by one person into the mouth of another (other than where that other person is unable to drink without assistance by reason of disability)

2. The responsible person must ensure that free potable water is provided on request to customers

## **PUBLIC PROTECTION**

where it is reasonably available.

#### Age Verification Policy

(1) The premises licence holder or club premises certificate holder must ensure that an age verification policy is adopted in respect of the premises in relation to the sale or supply of alcohol.

(2) The designated premises supervisor in relation to the premises licence must ensure that the supply of alcohol at the premises is carried on in accordance with the age verification policy.

(3) The policy must require individuals who appear to the responsible person to be under 18 years of age (or such older age as may be specified in the policy) to produce on request before being served alcohol, identification bearing their photograph, date of birth and either

- a) A holographic mark, or
- b) An ultraviolet feature

#### Below Cost Ban

A relevant person shall ensure that no alcohol is sold or supplied for consumption on or off the premises for a price which is less than the permitted price.

For the purposes of the condition set out in paragraph 1 -

(a) 'duty' is to be construed in accordance with the Alcoholic Liquor Duties Act 1979

(b) 'permitted price' is the price found by applying the formula -

$$P = D + (D \times V)$$

where -

- (i) P is the permitted price,
- (ii) D is the amount of duty chargeable in relation to the alcohol as if the duty were charged on the date of the sale or supply of the alcohol, and
- (iii) V is the rate of value added tax chargeable in relation to the alcohol as if the value added tax were charged on the date of the sale or supply of the alcohol;

(c) 'relevant person' means, in relation to premises in respect of which there is in force a premises licence -

- (i) the holder of the premises licence,
- (ii) the designated premises supervisor (if any) in respect of such a licence, or
- (iii) the personal licence holder who makes or authorises a supply of alcohol under such a licence;

(d) 'relevant person' means, in relation to premises in respect of which there is in force a club premises certificate, any member or officer of the club present on the premises in a capacity which enables the member or officer to prevent the supply in question; and

(e) 'value added tax' means value added tax charged in accordance with the Value Added Tax Act 1994.

#### Weights and Measures

## **PUBLIC PROTECTION**

The responsible person must ensure that:-

(a) where any of the following alcoholic drinks is sold or supplied for consumption on the premises (other than alcoholic drinks sold or supplied having been made up in advance ready for sale or supply in a securely closed container) it is available to customers in the following measures:-

1. Beer or cider - ½ pint;
2. Gin, rum, vodka or whisky - 25ml or 35ml; and
3. Still wine in a glass - 125ml; and

(b) These measures are displayed in a menu, price list or other printed material which is available to customers on the premises; and

(c) Where a customer does not in relation to a sale of alcohol specify the quantity of alcohol to be sold, the customer is made aware that these measures are available.

### **Where licence authorises the exhibition of films**

Admission of children (persons aged under 18) to the exhibition of films must be restricted in accordance with any recommendations made by the British Board of Film Classification.

### **Annex 2 – Conditions consistent with the Operating Schedule**

All conditions attached to the converted Public Entertainment Licence issued by Gloucester City Council under the Local Government (Miscellaneous Provisions) Act 1982 are preserved as conditions attached to this licence.

The maximum occupancy of the premises shall be 426 or any such other figure as may be advised in writing by Gloucestershire Fire and Rescue Services.

Any adult orientated productions are to be performed after 19:30 hrs. The premises will adhere to Gloucester City Council Guidelines should any performance contain striptease or nudity. No under 18's will be allowed admission to such performances.

An alarm system will be installed and maintained in working order.

### **Annex 3 – Conditions attached after a hearing by the licensing authority**

None

## **PUBLIC PROTECTION**

Gloucester City Council  
Herbert Warehouse  
The Docks  
Gloucester GL1 2EQ

Tel 01452 396303 Fax 01452 396340  
Email [licence.team@gloucester.gov.uk](mailto:licence.team@gloucester.gov.uk)  
Minicom 01452 396161  
[www.gloucester.gov.uk](http://www.gloucester.gov.uk)

**1601349GLPRMV**

Page 6 of 7

**Annex 4 – Plans**

As submitted with the application

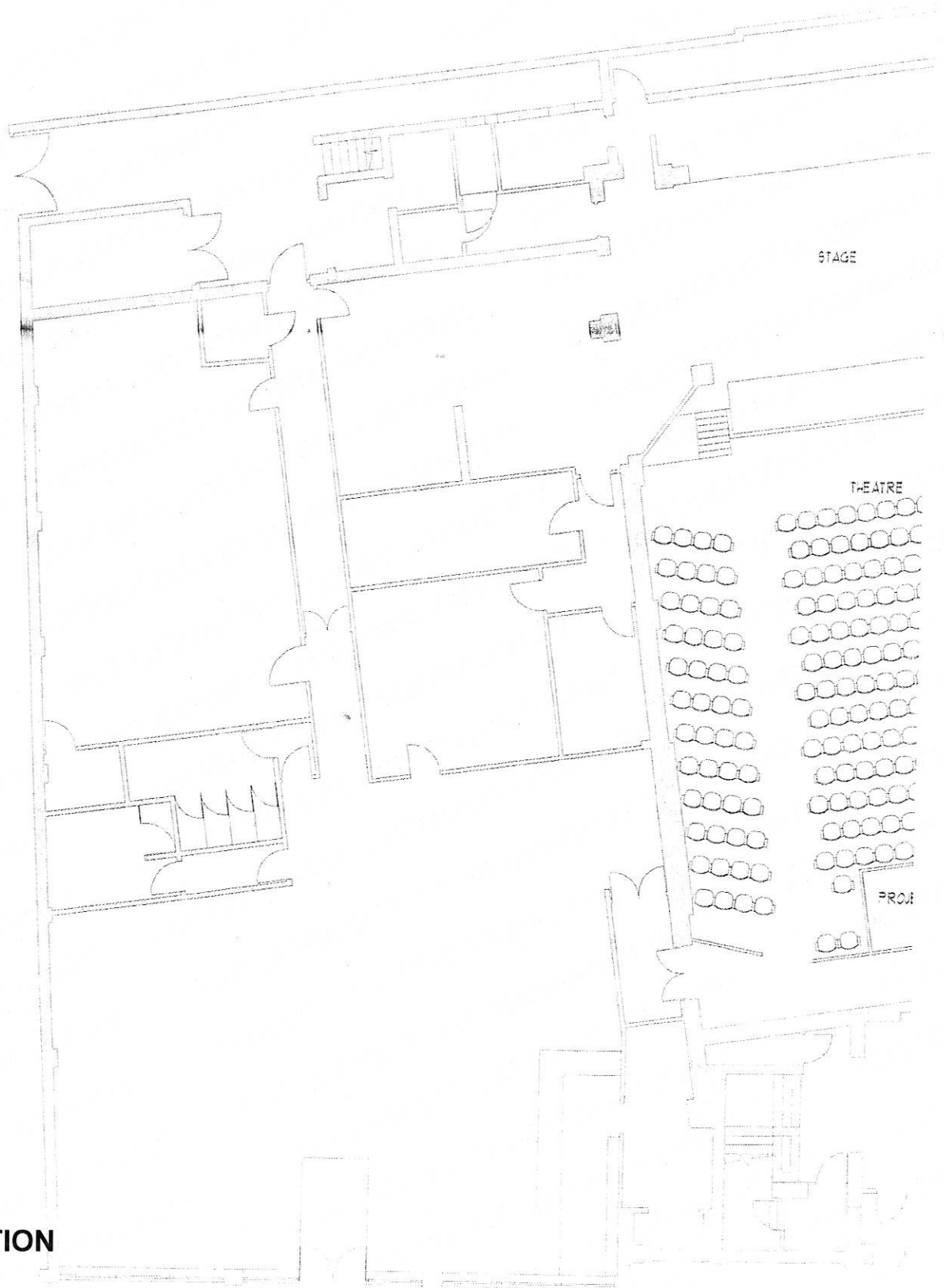

AC Design (UK) Ltd  
PROJECT  
CINE BAR FACILITY, PICTUREDROME THEATRE, JARROLD  
DRAWN BY  
Mr AVNI DUKA  
CHECKED BY  
PLAN  
Tel: 01452 531112

**PUBLIC PROTECTION**

Gloucester City Council  
Herbert Warehouse  
The Docks  
Gloucester GL1 2EQ

Tel 01452 396303 Fax 01452 396340  
Email [licence.team@gloucester.gov.uk](mailto:licence.team@gloucester.gov.uk)  
Minicom 01452 396161  
[www.gloucester.gov.uk](http://www.gloucester.gov.uk)

1601349GLPRMV



Part B

Premises Licence Summary

Premises Licence Number

1601349GLPRMV

Premises Details

**Postal address of premises, or if none, ordnance survey map reference or description, including Post Town, Post Code**

Olympus Cafe Bar  
162-170 Barton Street  
Gloucester  
Gloucestershire  
GL1 4EU

**Telephone number** 01452 525917

**Where the licence is time limited the dates**

Not applicable

**Licensable activities authorised by the licence and the times the licence authorises the carrying out of licensable activities**

Sale of Alcohol	Everyday	12:00 - 23:00
Plays	Everyday	10:00 - 00:00
Films	Everyday	10:00 - 00:00
Boxing or Wrestling Entertainment	Everyday	10:00 - 00:00
Live Music	Everyday	10:00 - 00:00
Recorded Music	Everyday	10:00 - 00:00
Performance of Dance	Everyday	10:00 - 00:00
Making Music	Everyday	10:00 - 00:00
Dancing	Everyday	10:00 - 00:00

Sale of alcohol on New Year's Eve from the start of permitted hours on New Year's Eve to the end of permitted hours on New Year's Day

**The opening hours of the premises**

Everyday 10:00 - 00:00 (Midnight)

Sale of alcohol on New Year's Eve from the start of permitted hours on New Year's Eve to the end of permitted hours on New Year's Day

PUBLIC PROTECTION



**Where the licence authorises supplies of alcohol whether these are on and / or off supplies**

Alcohol is supplied for consumption on the Premise

**Name, (registered) address of holder of premises licence**

Arben Ndreu  
162-170 Barton Street  
Gloucester  
GL1 4EU

**Registered number of holder, for example company number, charity number (where applicable)**

**Name, designated premises supervisor where the premises licence authorises for the supply of alcohol**

Arben Ndreu

**State whether access to the premises by children is restricted or prohibited**

**Signature of Issuing Officer:**



Food, Licensing & Markets Service Manager  
Public Protection

**Date Licence First Granted** 15 December 2005

**Date of Issue:** 9 September 2016

Issuing Authority:

The District of Gloucester City Council, The Docks, Gloucester GL1 2EQ